

# Mounting Hardware

## Universal Clamp

### Model CLUV

This model is a general purpose mounting clamp. It enables aerials to be mounted either in line vertically, or horizontally mounted to vertical or horizontal tubes/pipes. It will also accept the 25 mm square booms of our Commercial Yagis & Folded Dipoles.

#### Specification:

MODEL	CLUV
Body	Cast Aluminium Natural Finish
Hardware	2x CLUB120 U-Bolts
External Vertical Tube Diameter (mm)	38 or 48 Minimum 38 Maximum 50
Internal Vertical Tube Diameter (mm)	38 or 48 Minimum 25 Maximum 50
Internal Horizontal Tube Diameter (mm)	38 or 48 Minimum 25 Maximum 50 or 25 Square Tube
Dimensions (mm)	90 x 90 x 120
Weight (kg)	1.2

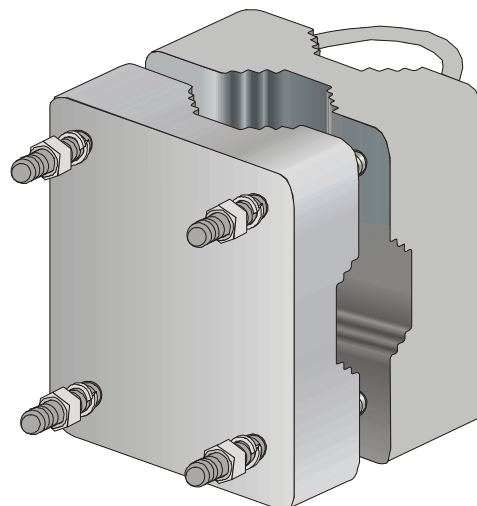

CLUV